

BIM Typical:

Operating Room

OR Equipment List		
Room: Name	Description	wcgARCHID
Operating Room	Anesthesia Machine	ANMA-01
Operating Room	Board, Patient Transfer Device	BPTD-01
Operating Room	Boom, Anesthesia	BOAN-01
Operating Room	Medical Equipment Delivery System	MEDS-01
Operating Room	Cart, Anesthesia	CAAN-02
Operating Room	Cart, Isolation	CAIS-01
Operating Room	Container, Sharps	COSH-01
Operating Room	Dispensing Unit, Drug, Anesthesia	DRDS-01
Operating Room	Electrosurgical Unit	ELUN-01
Operating Room	Glove Box Holder	GLBH-01
Operating Room	Headlight, w/ Light Source	HELS-01
Operating Room	Kickbucket	KICK-01
Operating Room	Light, Surgical, W Monitor	LSWM-01
Operating Room	Monitor & Keyboard	MOKE-01
Operating Room	Monitor, Accessory, Bracket	MOAB-03
Operating Room	Monitor, Flat Screen	MOFS-01
Operating Room	Rack, Apron	RAAP-02
Operating Room	Stand, Basin, Single	STBS-01
Operating Room	Stand, Biowaste	STBI-01
Operating Room	Stand, IV	STIV-01
Operating Room	Stand, Mayo	STMA-01
Operating Room	Stand, Regular Waste	STRW-01
Operating Room	Stand, Soiled Linen	STSL-01
Operating Room	Stool, Revolving	STRE-01
Operating Room	Stool, Step, Stackable	STSS-01
Operating Room	Stool, Surgeon	STSU-01
Operating Room	Table, Instrument	TAIN-01
Operating Room	Table, Instrument	TAIN-02
Operating Room	Table, Instrument	TAIN-03
Operating Room	Table, Surgical	TASU-01
Operating Room	Waste Disposal, Surgical Fluid Collection	WDSF-01
Operating Room	Workstation	WORK-01
Operating Room - Scrub Sink	Sink, Scrub	SISC-01
Operating Room - Stretcher Alcove	Cart, Resuscitation, Cardiac	CARC-01
Operating Room - Stretcher Alcove	Stretcher, Procedure / Recovery	STPR-01

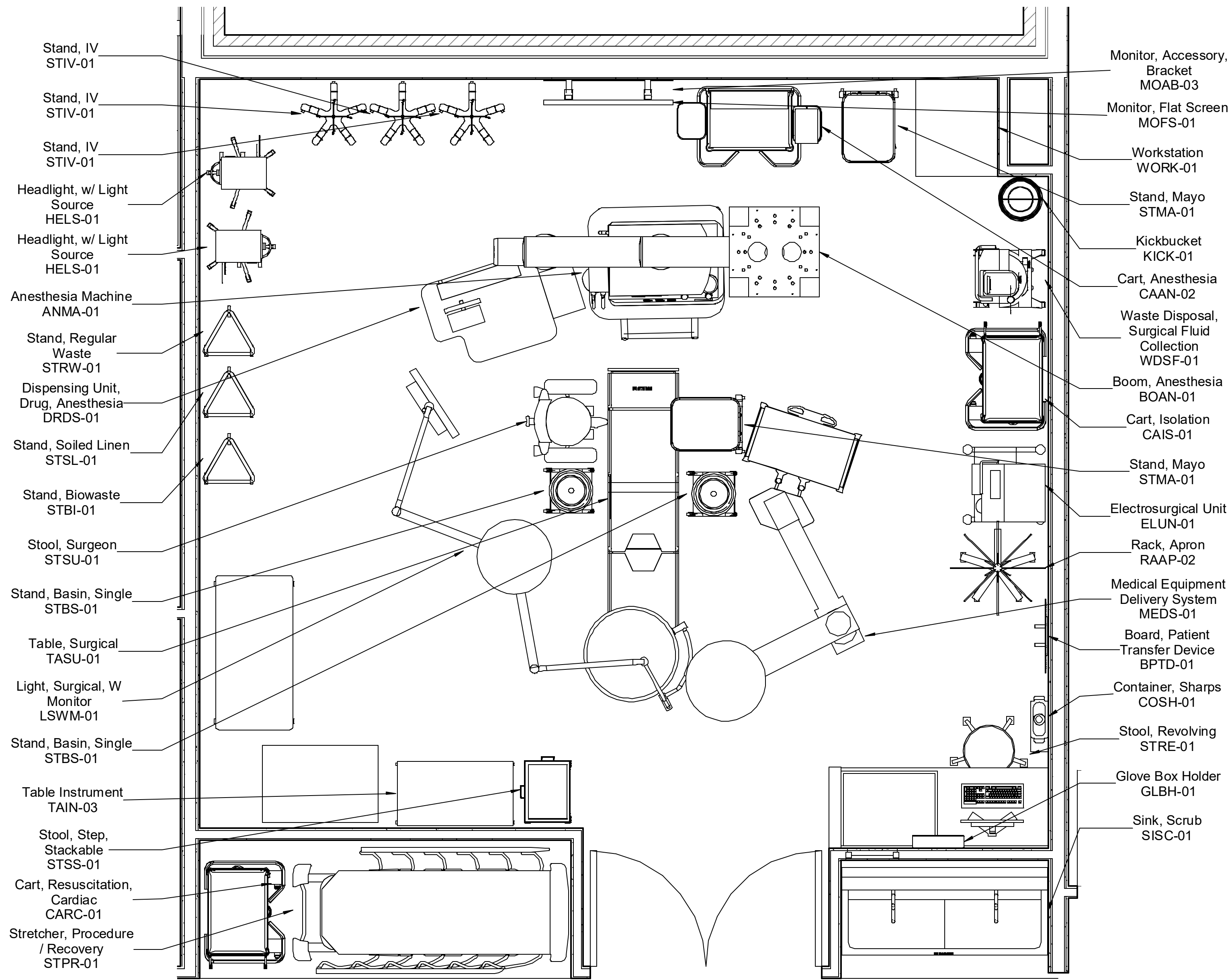

2 SR- OR
1/2" = 1'-0"

